



# Diagnostika '22



## PARTNERS BROCHURE

**2022 International Conference on Diagnostics in  
Electrical Engineering (Diagnostika)**

**IEEE Conference Record**

**#55131**

**Pilsen, Czech Republic**

## Invitation

On behalf of the Organizing Committee, it is my honor and pleasure to invite you to the 2022 International Conference on Diagnostics in Electrical Engineering (Diagnostika), which will take place at the University of West Bohemia in Pilsen, Czech Republic, September 6 – 8. 2022.

We would like again create a pleasant platform for the scientific exchange of experience for experts from universities, relevant industries and institutes experienced in the field of diagnostics in electrical engineering, measurement systems and manufacturers of electrical machines and appliances.

Looking forward to seeing you in Pilsen.

**Pavel Trnka**  
Chairman



**Václav Mentlík**  
Honorable Chairman



## Information for Partners

The CDEE 2022 continues a long tradition of the preceding Diagnostika conferences, starting in 1993.

The CDEE 2022 is traditionally organized by the University of West Bohemia (UWB), Faculty of Electrical Engineering and IEEE Czechoslovakia Section and gradually grown in an international event. CDEE 2022 is not the scientific conference only but hosting company presentations/exhibition as well.

CDEE team is welcoming patrons and exhibitors.



## Conference History

2022 International Conference on Diagnostics in Electrical Engineering, CDEE 2022 is a traditional scientific conference held by the Department of Materials and Technology of the Faculty of Electrical Engineering, University of West Bohemia in Pilsen. The purpose of this biennial conference organized since 1993 is to share the latest events and developments in the field of diagnostics. CDEE 2022 event will be the fourteenth meeting of scientists and experts involved in electrical engineering diagnostics. As usual, everyone interested in electrical engineering, structure of materials, their features and applications in electrical systems will have an opportunity for the professional exchange of knowledge and research results.

## Conference topics

The conference is structure to oral and poster sessions.

- ⚡ **Laboratory Methods of Diagnostics**
- ⚡ **Theories, Methods and Models**
- ⚡ **On-Site Testing of Electrical Appliances**
- ⚡ **Condition Monitoring**
- ⚡ **Electrical Insulation Properties and Structural Changes**
- ⚡ **Electric Machines and Devices**
- ⚡ **Other Diagnostic Methods**

## International Technical Committee

|   |  |   |  |
|---|--|---|--|
|  Andrei Bezborodov |  Jian Li          |  Jan Subocz        |  Christian Weindl |
|  Ricardo Diaz      |  Pavel Mach       |  Suwarno           |  Yoji Fujita      |
|  Miroslav Gutten   |  Michael Muhr     |  Zoltán Ádam Tamus |  |
|  Rainer Haller     |  Zdeněk Peroutka  |  Pavel Trnka       |  |
|  Marian Kampik     |  Alena Pietriková |  Magdaléna Trnková |  |
|  Stefan Kornhuber  |  Radek Procházka  |  Stane Vižintin    |  |
|  Jozef Kúdelčík    |  Yong-June Shin   |  Feipeng Wang      |  |

## Scientific Committee

|                                    |                                     |
|------------------------------------|-------------------------------------|
| Bezděk, Z. (COGEBI a.s.)           | Šmatlík, J. (BEZ International)     |
| Karban, P. (UWB)                   | Velek, J. (ČEPS a.s.)               |
| Mach, F. (IEEE)                    | Novák, P. (1. SERVIS-ENERGO s.r.o.) |
| Mentlík, V. (UWB)                  | Steiner, F. (UWB)                   |
| Michalík, J. (EVPU a.s.)           | Šašek, L. (Independent Consultant)  |
| Šilhánek, J. (Škoda Electric a.s.) | Welsch, A. (UNI Regensburg)         |
| Sobotka, L. (Škoda Electric a.s.)  | Choc R. (ETD Transformátory a.s.)   |
| Špánik, P. (University of Žilina)  |                                     |

## Organizing Committee

|            |           |             |
|------------|-----------|-------------|
| Pihera, J. | Mužík, M. | Michal, O.  |
| Prosr, P.  | Tupa, J.  | Leffler, J. |

Junior Members: Andrea Benešová, Jiří Kopřiva

|  |                                     |                                    |                                 |
|--|-------------------------------------|------------------------------------|---------------------------------|
| <b>prof. Ing. Václav Mentlík, CSc.</b> | <b>doc. Ing. Pavel Trnka, Ph.D.</b> | <b>Ing. Jaroslav Hornak, Ph.D.</b> | <b>Ing. Josef Pihera, Ph.D.</b> |
| <b>(Honorable Chairman)</b>            | <b>(Conference Chairman)</b>        | <b>(Co-Chair)</b>                  | <b>(Secretary)</b>              |

## Conference Fees

The registration fee include conference proceedings, all session attendance, break refreshments, lunches, social event and gala dinner.

| Category             | Early Bird<br>(before June 1st 2022) | Regular<br>(after June 1st 2022) |
|----------------------|--------------------------------------|----------------------------------|
| IEEE Member**        | 370 €                                | 420 €                            |
| Non-IEEE Member**    | 420 €                                | 475 €                            |
| Extra Paper***       |                                      | 80 €                             |
| Accompanying Person* |                                      | 200 €                            |

\* Accompanying Person Kit contains lunch on September 7 and 8, Dinner September 6 & Social Event and Dinner September 7  
 \*\* The conference will support limited number of student with discount. For more information please contact: [jhornak@fel.zcu.cz](mailto:jhornak@fel.zcu.cz)  
 \*\*\* One author and one paid conference fee max. 2 papers, extra paper fee is 80 €

## Patronage Options

You are invited to contribute to the successful organisation of this event in one or more of the following ways:

- \*as a patron of the Conference,
- \*as an advertiser in Conference materials (Program book, leaflets in the Conference bag),
- \*as an internet advertise,
- \*as a patron of invited speaker,
- \*by participating in the Conference exhibition of technical and commercial products,
- \*by a special presentation of your products (social events, opening ceremony, etc.)
- \*other items (Conference bag, badges, etc.)
- \*your own suggestions are welcomed.

### Platinum

Please contact us for further information.

### Gold and Silver

| Packages for Patrons                  | GOLD                          | SILVER                        |
|---------------------------------------|-------------------------------|-------------------------------|
| Complimentary registration            | 2 persons                     | 2 persons                     |
| Exhibition space                      | ✓                             | ✗                             |
| Logo exposure on official website     | ✓                             | ✓                             |
| Logo exposure on the banners          | ✓                             | ✓                             |
| Advertising in program book           | ✓                             | ✗                             |
| Promo brochures in the conference bag | ✓                             | ✗                             |
|                                       | 3 500 €*<br>*VAT not included | 2 000 €*<br>*VAT not included |

Participants based on country origin (CDEE 2020)

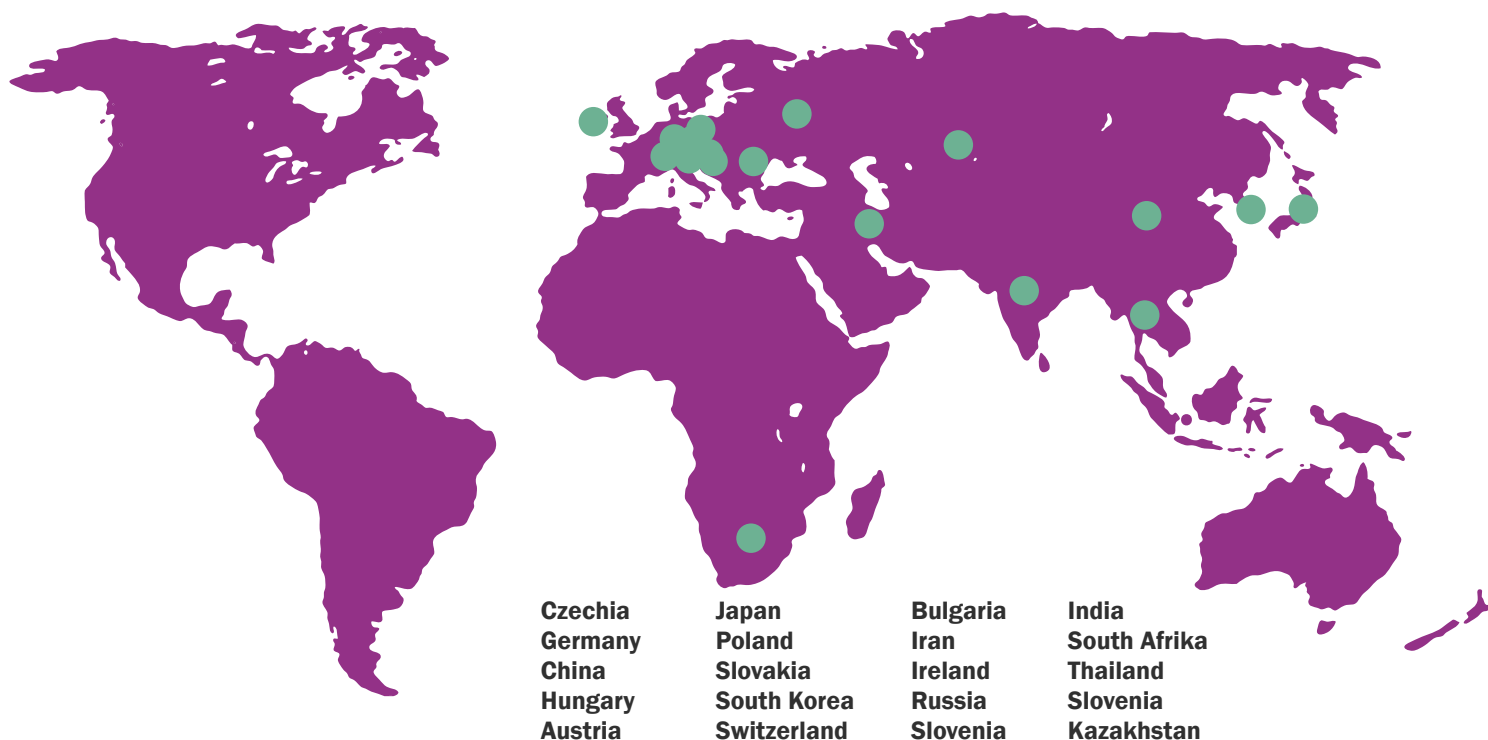

## Venue

Congress Centre Parkhotel Pilsen, U Borského parku 31, 320 04 Pilsen, Czech Republic (<http://www.parkhotel-czech.eu/>)



## Exhibition

The exhibition will be located in the Foyer Lobby, Foyer Conferenza, Conferenza, Parkhotel.

Space rental per m<sup>2</sup> is: 250 € (minimum 4 m<sup>2</sup>) (one person fee included)

Allocation of space will be treated as a first-come first-served basis (except for Platinum and Golden patrons).

## Payment

### Deadline for payment of:

- patronage: depends on the contract,
- advertisement in the Program book: June 30, 2022

### Payments - without any charges to the beneficiary - can be made:

- by bank transfer (€ or CZK), for more details please contact: [tupa@fel.zcu.cz](mailto:tupa@fel.zcu.cz)

### Cancellation

Terms of cancellation will be defined in the contract.

## Preliminary plan of exhibitions

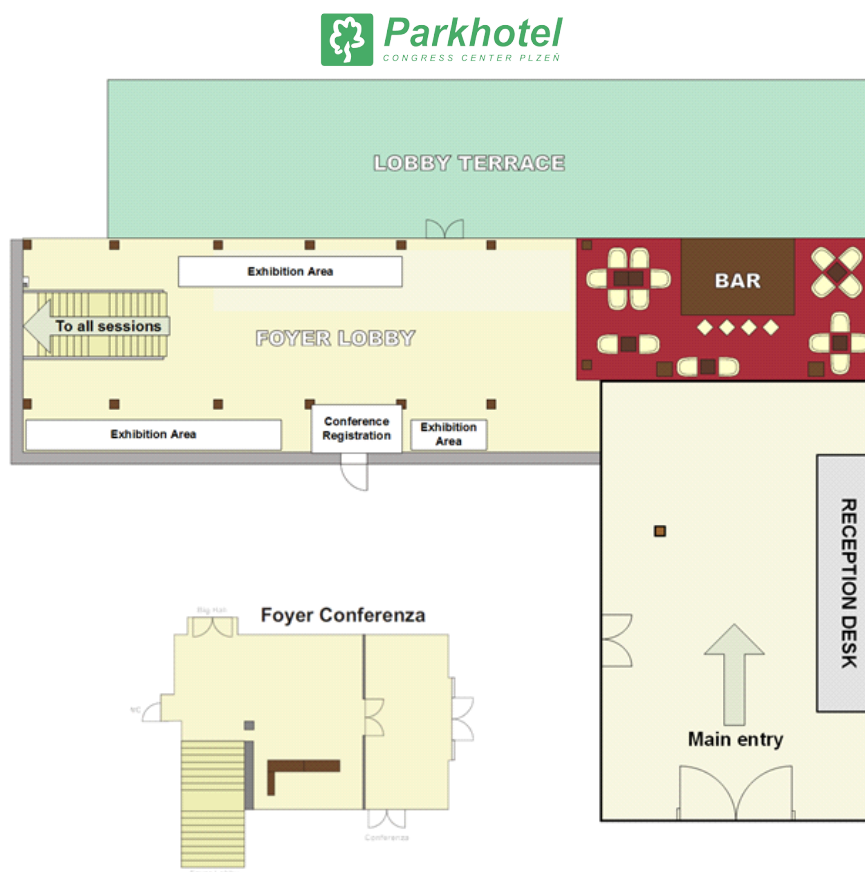

## Contact Details



 <https://diagnostika.zcu.cz/>

 [cdee@ket.zcu.cz](mailto:cdee@ket.zcu.cz)

## Organizers

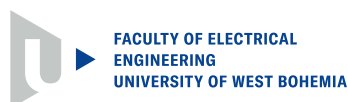

<https://fel.zcu.cz>



<https://rice.zcu.cz>



<https://www.ieee.cz/en>

University of West Bohemia in Pilsen  
Faculty of Electrical Engineering  
Department of Materials and Technology  
Univerzitní 8, 306 14 Pilsen, Czech Republic

**doc. Ing. Pavel Trnka, Ph.D.**  
**(Conference Chairman)**

Phone: 00420 37763 4518  
GSM: 00420 735 715 957  
[pavel@fel.zcu.cz](mailto:pavel@fel.zcu.cz)

**Ing. Josef Pihera, Ph.D.**  
**(Secretary)**

GSM: 00420 724 936 679  
[pihera@fel.zcu.cz](mailto:pihera@fel.zcu.cz)